

TA109

VHD68 – HD68 Cable

1.8 m cable with one VHD68 SCSI-V male and one HD68 SCSI-3 male type connector

Version 1.0

User Manual

Issue 1.0.3

May 2011

TA109-10R**VHD68 – HD68 Cable**

1.8 m cable with one VHD68 SCSI-V male and one HD68 SCSI-3 male type connector

This document contains information, which is proprietary to TEWS TECHNOLOGIES GmbH. Any reproduction without written permission is forbidden.

TEWS TECHNOLOGIES GmbH has made any effort to ensure that this manual is accurate and complete. However TEWS TECHNOLOGIES GmbH reserves the right to change the product described in this document at any time without notice.

TEWS TECHNOLOGIES GmbH is not liable for any damage arising out of the application or use of the device described herein.

Style Conventions

Hexadecimal characters are specified with prefix 0x, i.e. 0x029E (that means hexadecimal value 029E).

For signals on hardware products, an 'Active Low' is represented by the signal name with # following, i.e. IP_RESET#.

©2009-2011 by TEWS TECHNOLOGIES GmbH

All trademarks mentioned are property of their respective owners.

Issue	Description	Date
1.0.0	First Issue	December 2009
1.0.1	Corrected Typo in Table 2-1 : Cable Pin Assignment	February 2010
1.0.2	Extension "Product Description"	January 2011
1.0.3	- Pin number typo corrected in Figure 3-1: Assembly Drawing - Clarification of connector naming	May 2011

Table of Contents

1	PRODUCT DESCRIPTION	5
2	CABLE PIN ASSIGNMENT	6
3	ASSEMBLY DRAWING.....	7

List of Figures

FIGURE 3-1 : ASSEMBLY DRAWING.....	7
------------------------------------	---

List of Tables

TABLE 2-1 : CABLE PIN ASSIGNMENT	6
--	---

1 Product Description

The TA109 represents a one to one connection. One side of the 68 pin cable is mounted to a 68 pin VHD68 male SCSI-V type connector (also known as VHDCI) and the other side is connected to a HD68 male SCSI-3 type connector. This cable provides a connection to TEWS modules with front I/O VHD68 connectors like the TAMC200 or TAMC863.

The TA109 VHD68 – HD68 Cable in conjunction with a TA203 HD68 terminal block could be used for prototyping and also for series.

The permissible maximum voltage for the TA109 is 30V DC.

Length of the TA109 VHD68 – HD68 Cable is at least 1.8 m.

2 Cable Pin Assignment

X1 male HD68	X2 male VHD68	X1 male HD68	X2 male VHD68
1	1	35	35
2	2	36	36
3	3	37	37
4	4	38	38
5	5	39	39
6	6	40	40
7	7	41	41
8	8	42	42
9	9	43	43
10	10	44	44
11	11	45	45
12	12	46	46
13	13	47	47
14	14	48	48
15	15	49	49
16	16	50	50
17	17	51	51
18	18	52	52
19	19	53	53
20	20	54	54
21	21	55	55
22	22	56	56
23	23	57	57
24	24	58	58
25	25	59	59
26	26	60	60
27	27	61	61
28	28	62	62
29	29	63	63
30	30	64	64
31	31	65	65
32	32	66	66
33	33	67	67
34	34	68	68

Table 2-1 : Cable Pin Assignment

3 Assembly Drawing

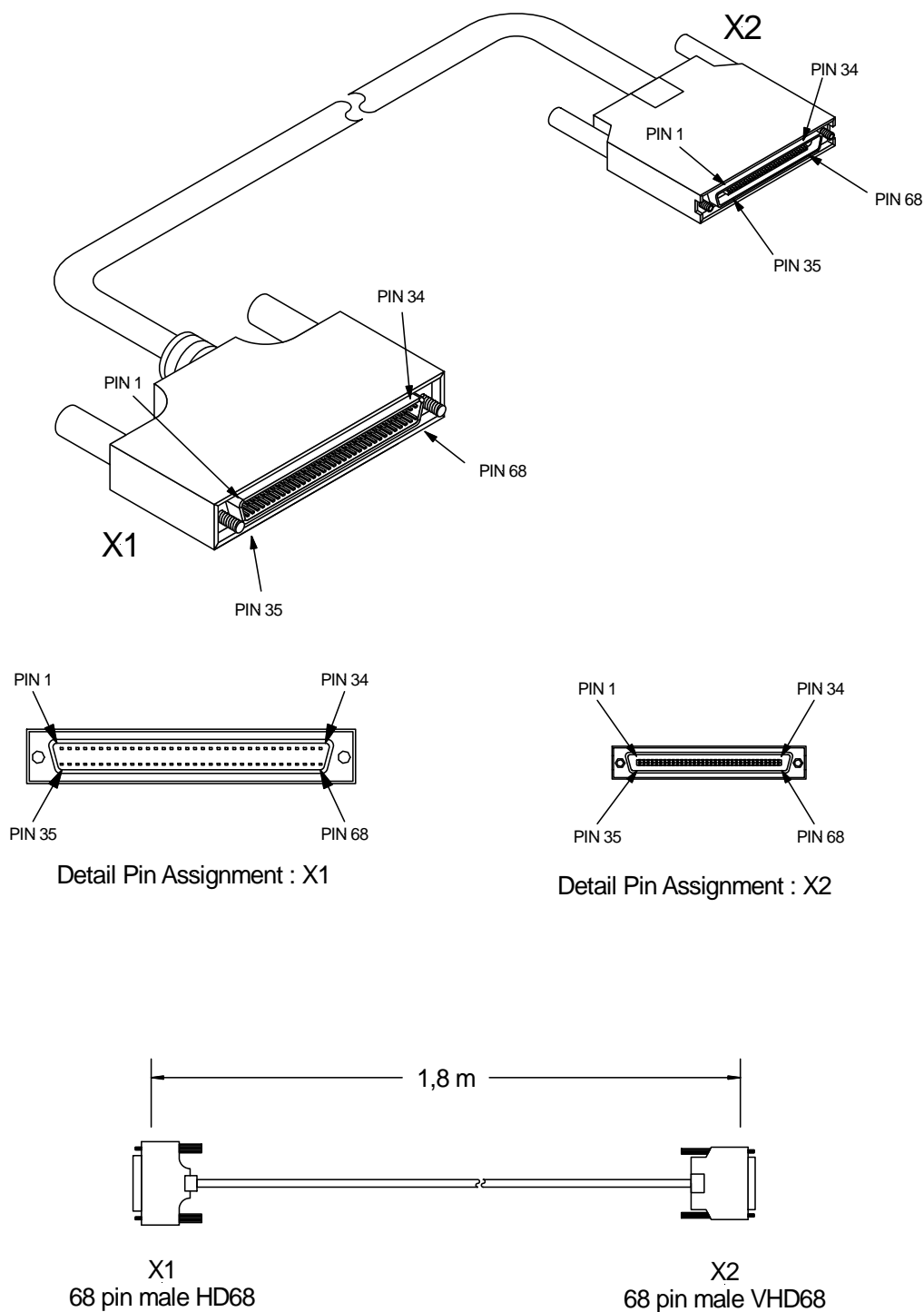

Figure 3-1 : Assembly Drawing